

DUAL IMPELLER CENTRIFUGAL ELECTRIC PUMPS

in AISI 304

SECTIONAL VIEW

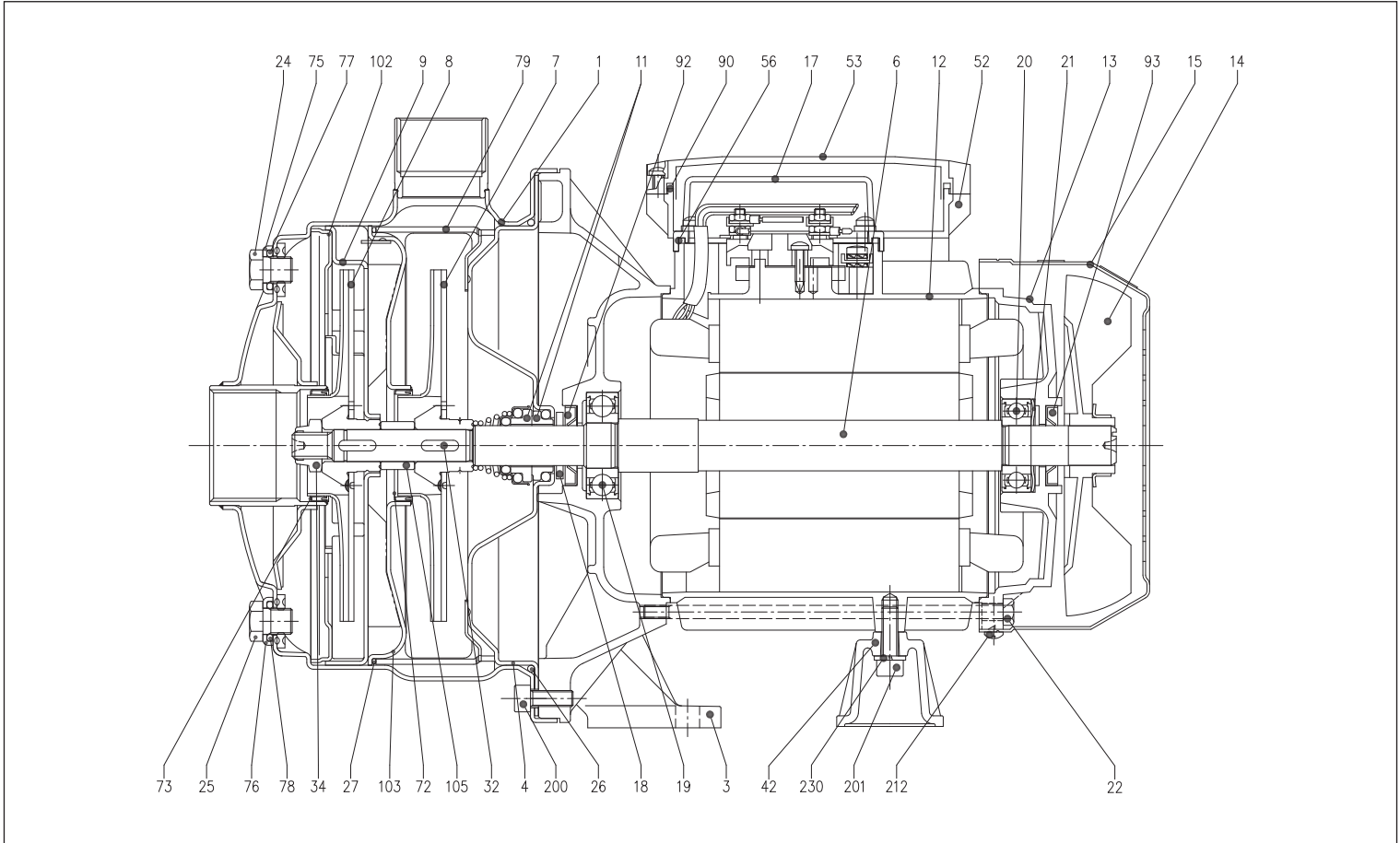

MATERIALS TABLE

Ref.	Name	Materials	Ref.	Name	Materials
1	Pump casing	EN 1.4301 (AISI 304)	32	Key	AISI 316
3	Motor bracket	Aluminium (up to 1.5 kW included) Cast iron (from 2.2 kW and above)	34	Impeller nut	Stainless steel A2-70
4	Casing cover	EN 1.4301 (AISI 304)	42	Motor support	Aluminium
6	Shaft	EN 1.4301 (AISI 304) Part in contact with the liquid	52	Terminal box [2]	ABS
7	Impeller	EN 1.4301 (AISI 304)	53	Terminal box cover [2]	ABS
8	Impeller	EN 1.4301 (AISI 304)	56	Terminal box cover gasket	NBR
9	Diffuser	EN 1.4301 (AISI 304)	72	Casing ring [4]	NBR
11	Mechanical seal	Ceramic/Carbon/NBR	73	Casing ring [4]	NBR
12	Motor frame	-	75	Washer	EN 1.4301 (AISI 304)
13	Motor cover	Aluminium	76	Washer	EN 1.4301 (AISI 304)
14	Fan	PA	77	O-Ring [3]	NBR
15	Fan cover	Galvanised Fe P04	78	O-Ring [3]	NBR
17	Terminal box cover [1]	Aluminium	79	Diffuser spacer	EN 1.4301 (AISI 304)
18	Splash ring	NBR	90	Gasket [2]	NBR
19	Bearing (pump side)	-	92	Seal ring	NBR
20	Bearing (motor side)	-	93	Seal ring	NBR
21	Adjusting ring	Steel C70	102	Diffuser cover	EN 1.4301 (AISI 304)
22	Tie-rod	Galvanised Fe 42	103	Conveyor cover	EN 1.4301 (AISI 304)
24	Plug	EN 1.4301 (AISI 304)	105	Impeller spacer	EN 1.4301 (AISI 304)
25	Plug	EN 1.4301 (AISI 304)	200	Screw (pump body)	Stainless steel A2-70
26	O-Ring [3]	NBR	201	Screw	Zn. Steel cl.8.8
27	O-Ring [3]	NBR	212	Screw	Stainless steel A2
			230	Washer	Steel C70

[1]= Three phase only
 [2]= Single phase only
 [3]= FPM for H-HS-HW-HSW versions, EPDM for E version
 [4]= FPM for H-HS-HW-HSW versions, NBR for E version